

THIS DRAWING IS UNPUBLISHED. RELEASED FOR PUBLICATION, 19 .
 © COPYRIGHT 19 BY AMP INCORPORATED. ALL INTERNATIONAL RIGHTS RESERVED.

LOC	DIST	P	F	ZONE	LTR	DESCRIPTION	DATE	APPD
CM	00				A	REVISED PER EC 0G3B-0215-02	25-APR-02	KW DC

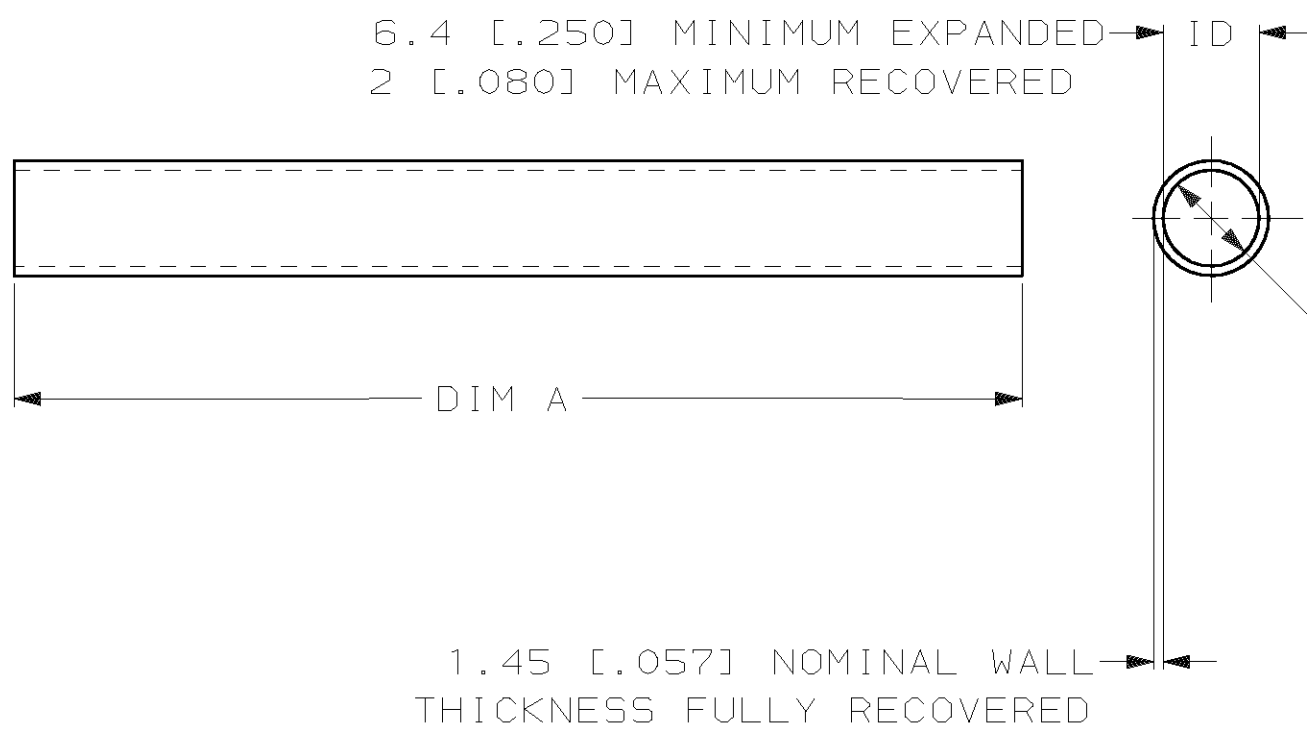

- 1 MATERIAL: TUBING, RED POLYOLEFIN, TYPE DWP31, HEAT SHRINKABLE, FLAME RETARDANT AND MEETS UL 224 ALL TUBING.
- 2 ADHESIVE APPLIED ENTIRE INSIDE LENGTH OF TUBING.

1.22 m [4 FEET] MINIMUM		569152-2
0.3 m [1 FOOT] MINIMUM		569152-1
DIM A		PART NO
DO NOT SCALE PRINT. UNLESS SPECIFIED DIMENSIONS IN mm [INCHES] TOLERANCES ON: 2 PLC DEC ± - 3 PLC DEC ± - ANGLES ± -	DR 2-7-95 W CHANDLER	AMP Incorporated Harrisburg, PA 17105-3608
	CHK 2-15-95 D HUSSEY	
	APPD 2-15-95 D KAAT	NAME
	APPD 2-15-95 F HARNED	AMPSULATION DWP31, HST, 1/4 INCH ID, RED
MATERIAL	PRODUCT SPEC	SIZE
FINISH	APPLICATION SPEC	CAGE CODE
	WEIGHT	DRAWING NO
		SCALE
		SHEET

THIS DRAWING IS A CONTROLLED DOCUMENT FOR AMP INCORPORATED. IT IS SUBJECT TO CHANGE AND THE CONTROLLING ENGINEERING ORGANIZATION SHOULD BE CONTACTED FOR THE LATEST REVISION.